



INNOVATIVE ENERGY, INC.

Your Single Source for Reflective Insulation Products

R-VALUE <sup>up to</sup> **6.0**

DO-IT-YOURSELF

# Garage Door INSULATION KIT

**HELPS REDUCE RADIANT HEAT BUILDUP IN YOUR GARAGE!**

- **ALL-IN-ONE KIT**  
CONTAINS EVERYTHING YOU NEED TO  
INSULATE YOUR EXISTING GARAGE DOOR
- **IMPROVES THERMAL PERFORMANCE**
- **EASILY INSTALLS IN 60 MINUTES OR LESS!**

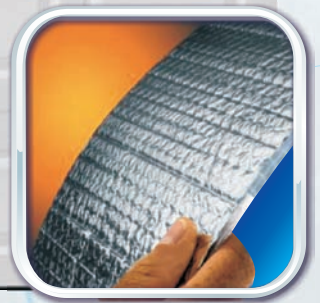
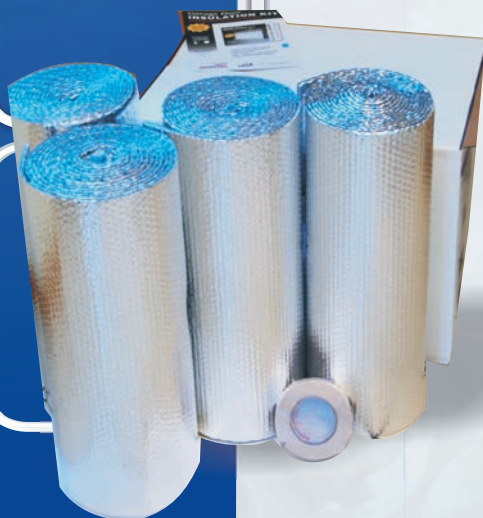

www.insul.net **800-776-3645**

# Garage Door INSULATION KIT

## Installation Instructions

**READ ALL INSTRUCTIONS  
BEFORE STARTING!**

**HELPS REDUCE RADIANT HEAT BUILDUP IN YOUR GARAGE!**

### Materials Included in Kit:

- (4) 24" x 18' long rolls of reflective insulation\*
- (1) 1 1/2" x 60 yard roll double sided tape
- (1) Disposable knife
- (1) Tape measure
- (5) Single-use alcohol cleansing wipes

**Kit contains enough insulation to accommodate up to an 18' x 8' door. \***

\*Rolls can easily be cut down to fit smaller door sizes.

## DIRECTIONS

**STEP 1.** Using alcohol wipes supplied, clean garage door panel framework where reflective insulation is to be applied. Make sure any debris is removed prior to applying double-sided tape.

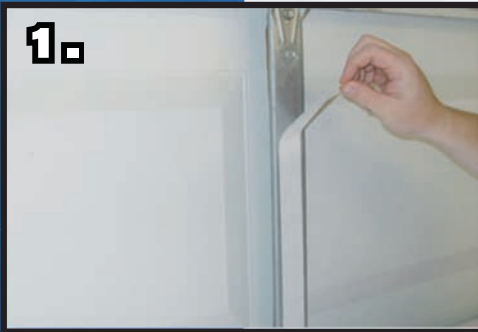

**STEP 2.** Peel one side of double-sided tape and press firmly & evenly to garage door panel framework. Cover any and all framework horizontally and vertically where insulation is to be applied. The double-sided tape should be applied at a temperature of 65°F - 100°F.



**STEP 3.** Measure and cut each roll of insulation to fit over the mounted strips of double-sided tape. Test fit each piece to ensure proper sizing for each panel. Remove the release liner from the tape and firmly press the reflective insulation against the adhesive working from side to side or top to bottom. Trim any excess insulation.

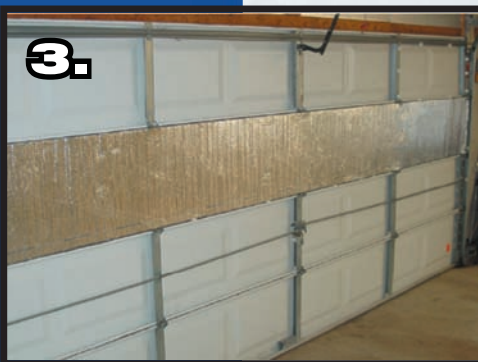

**Note:**  
Please wear proper  
safety equipment



**INNOVATIVE ENERGY, INC.**  
*Your Single Source for Reflective Insulation Products*

[www.insul.net](http://www.insul.net) **800-776-3645**

